

3021N

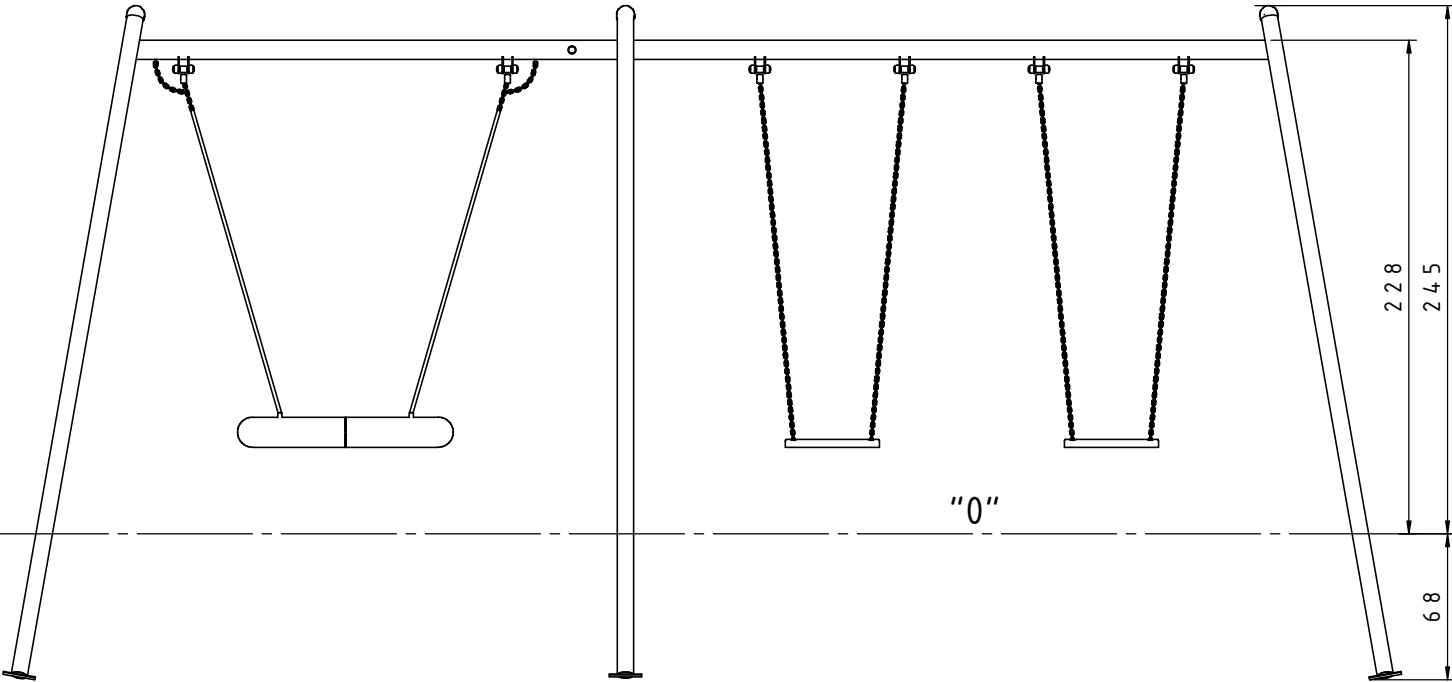

3021F

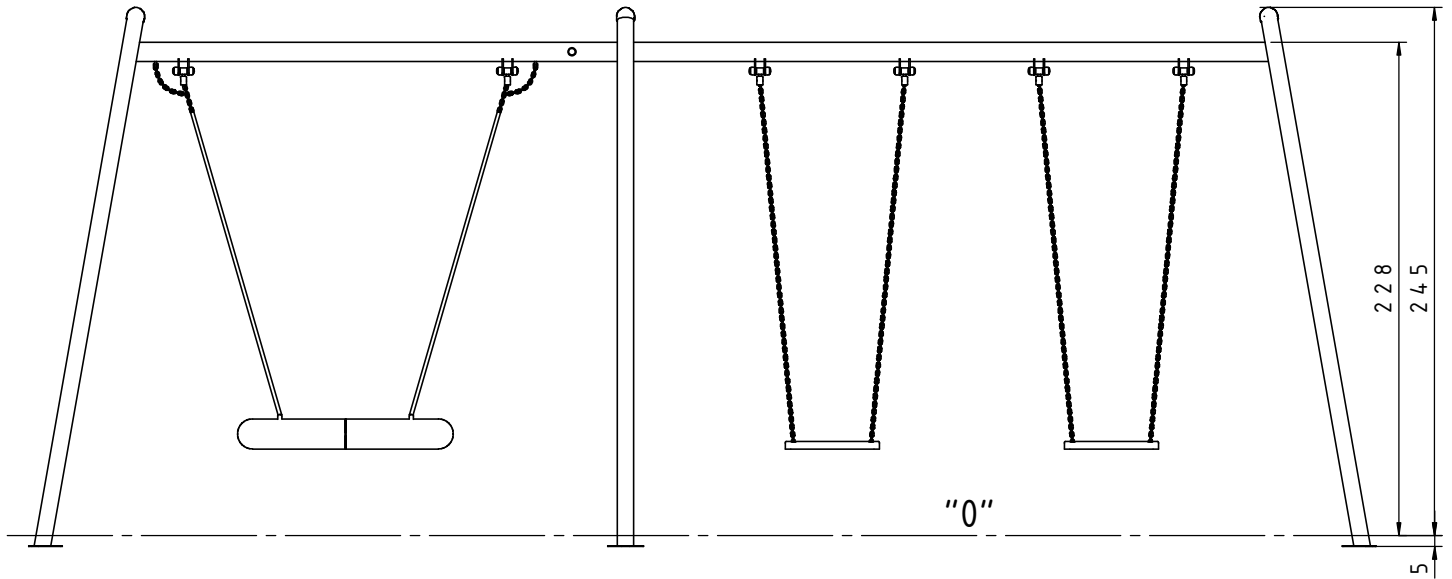

3021N

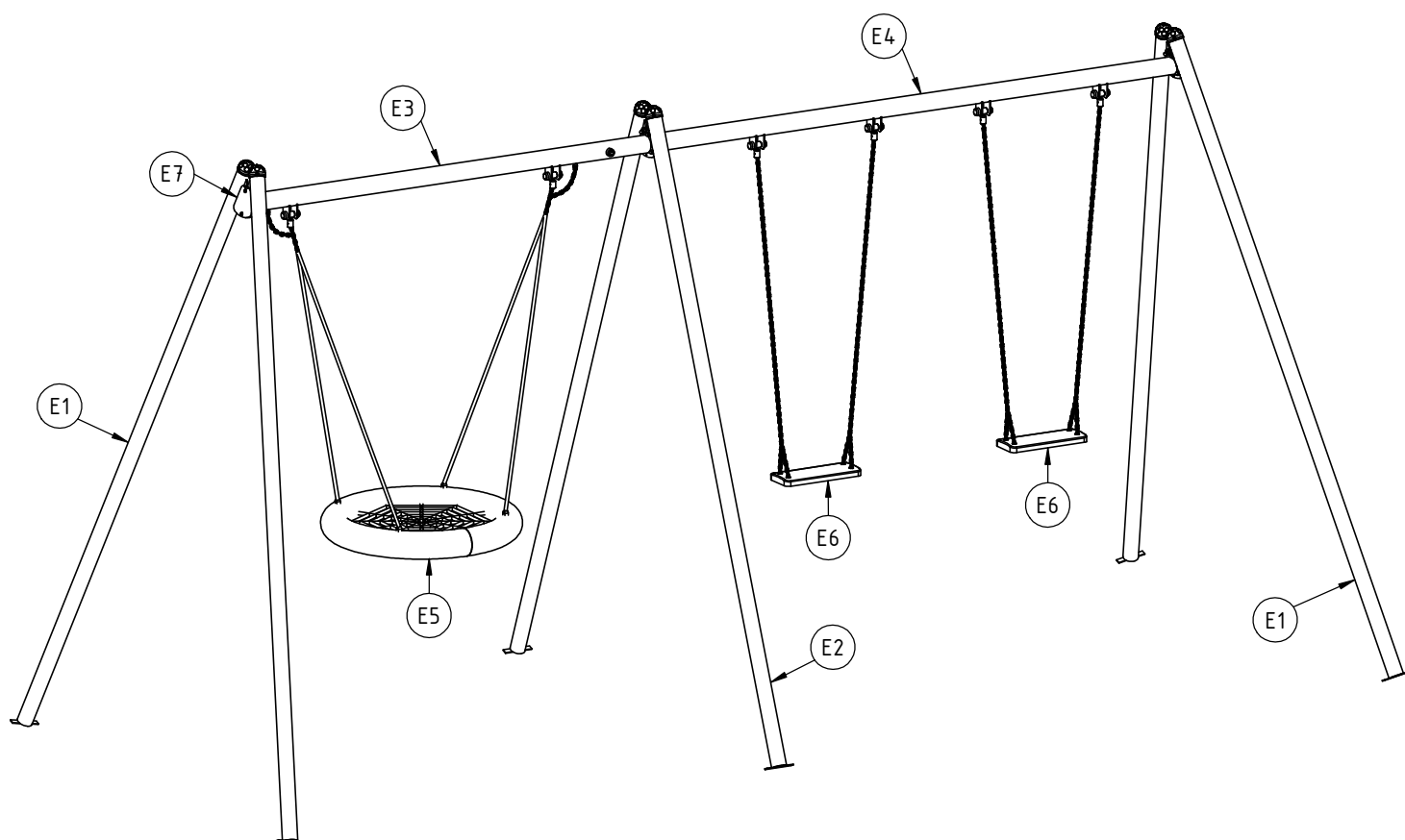

3021F

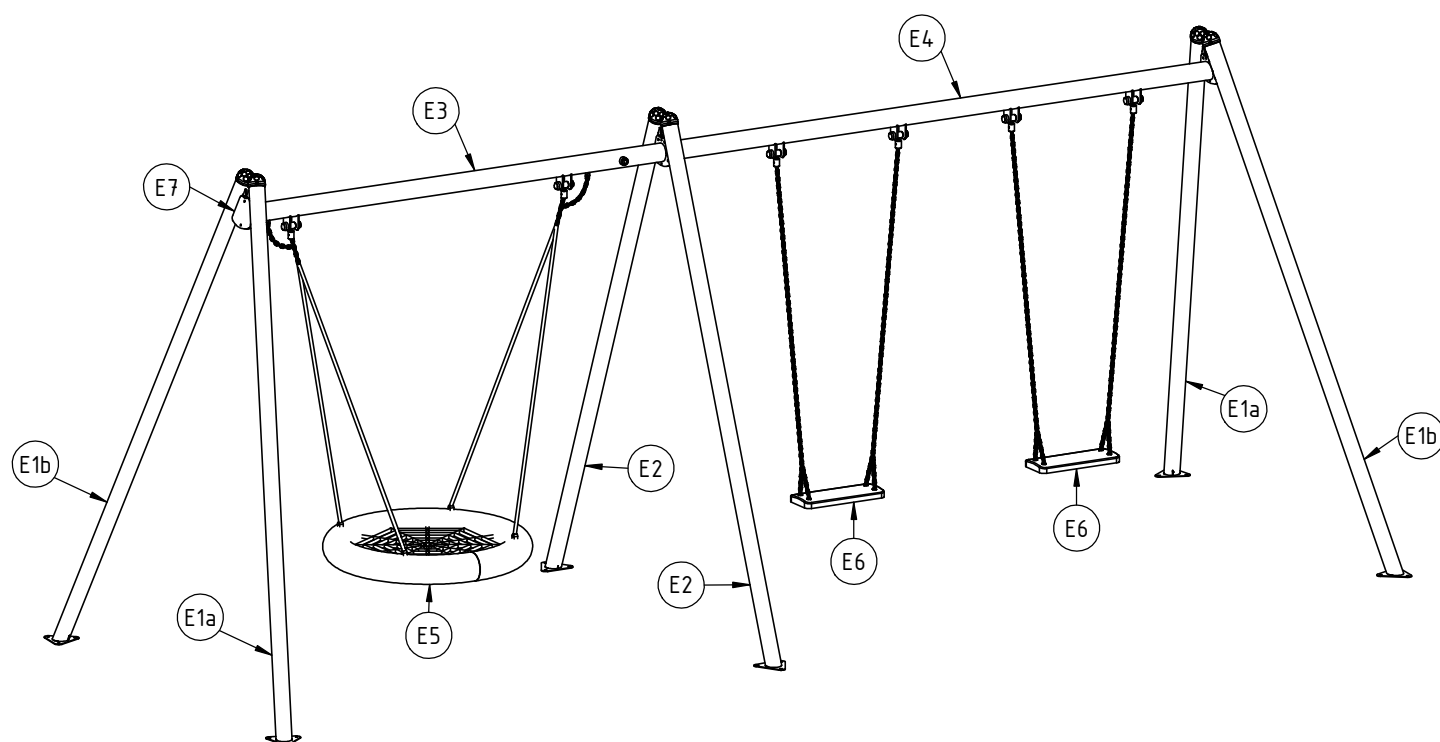

3021N  
3021F

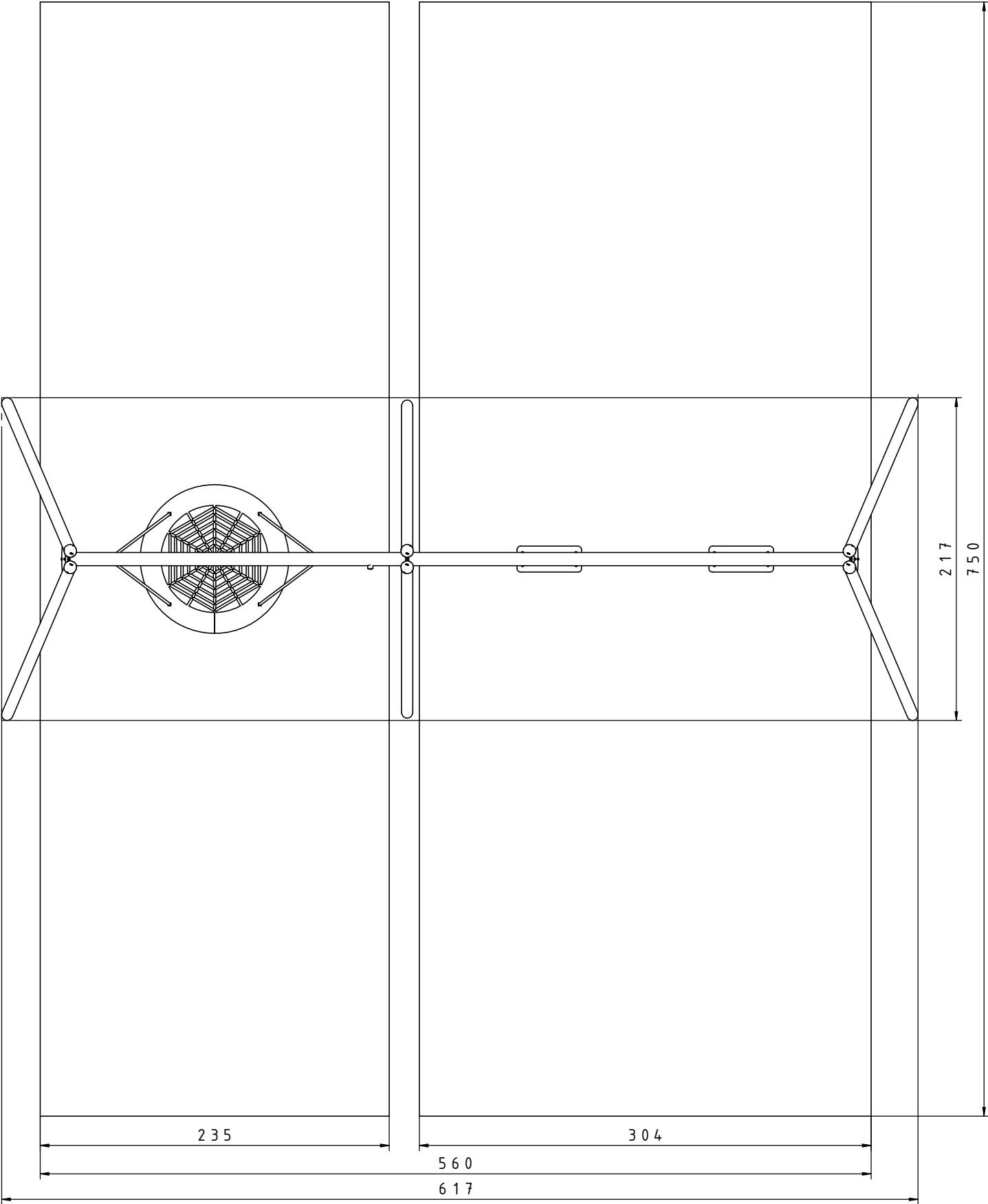

1

3021N  
3021F



INST\_30\_64A  
INST\_30\_64B

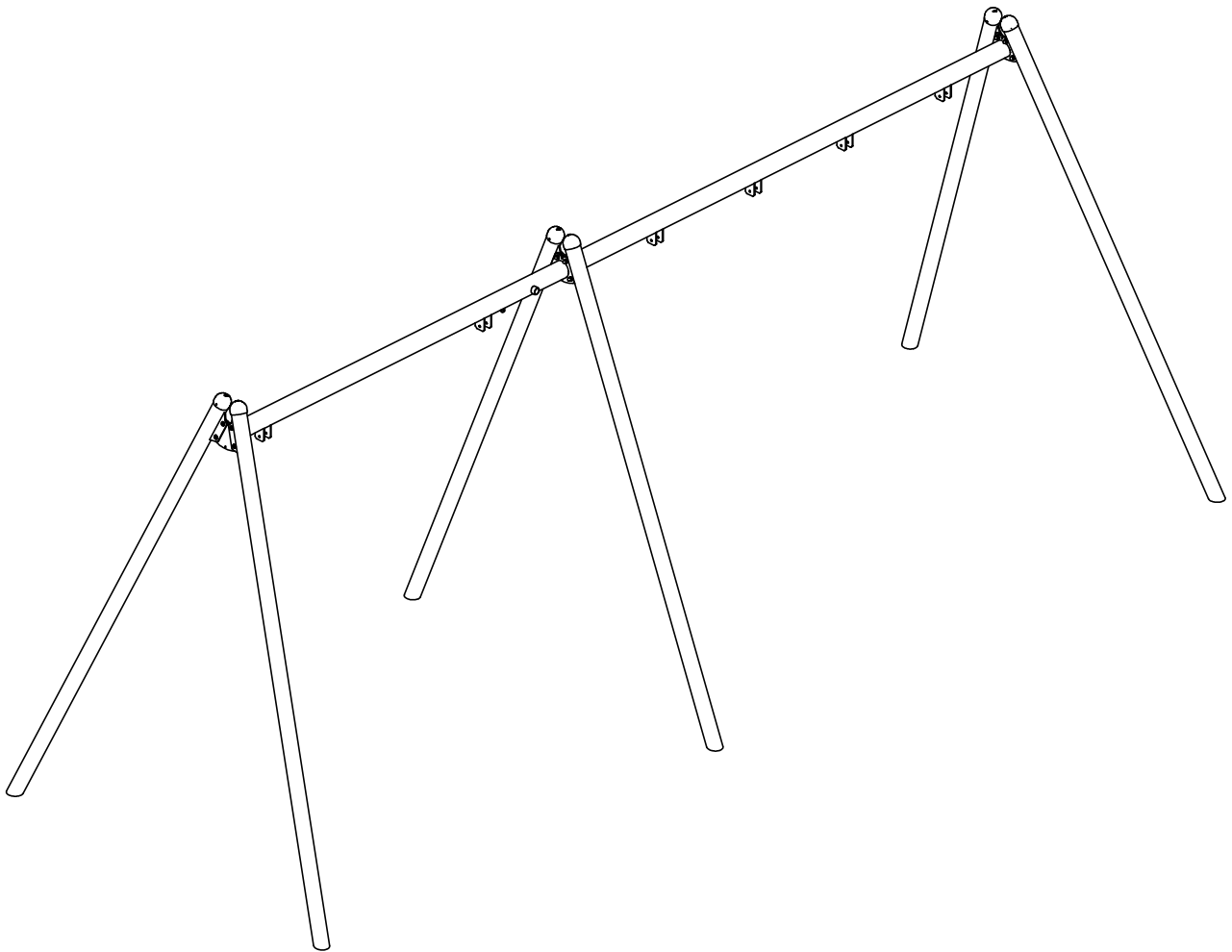

2

3021N  
3021F



INST\_30\_70

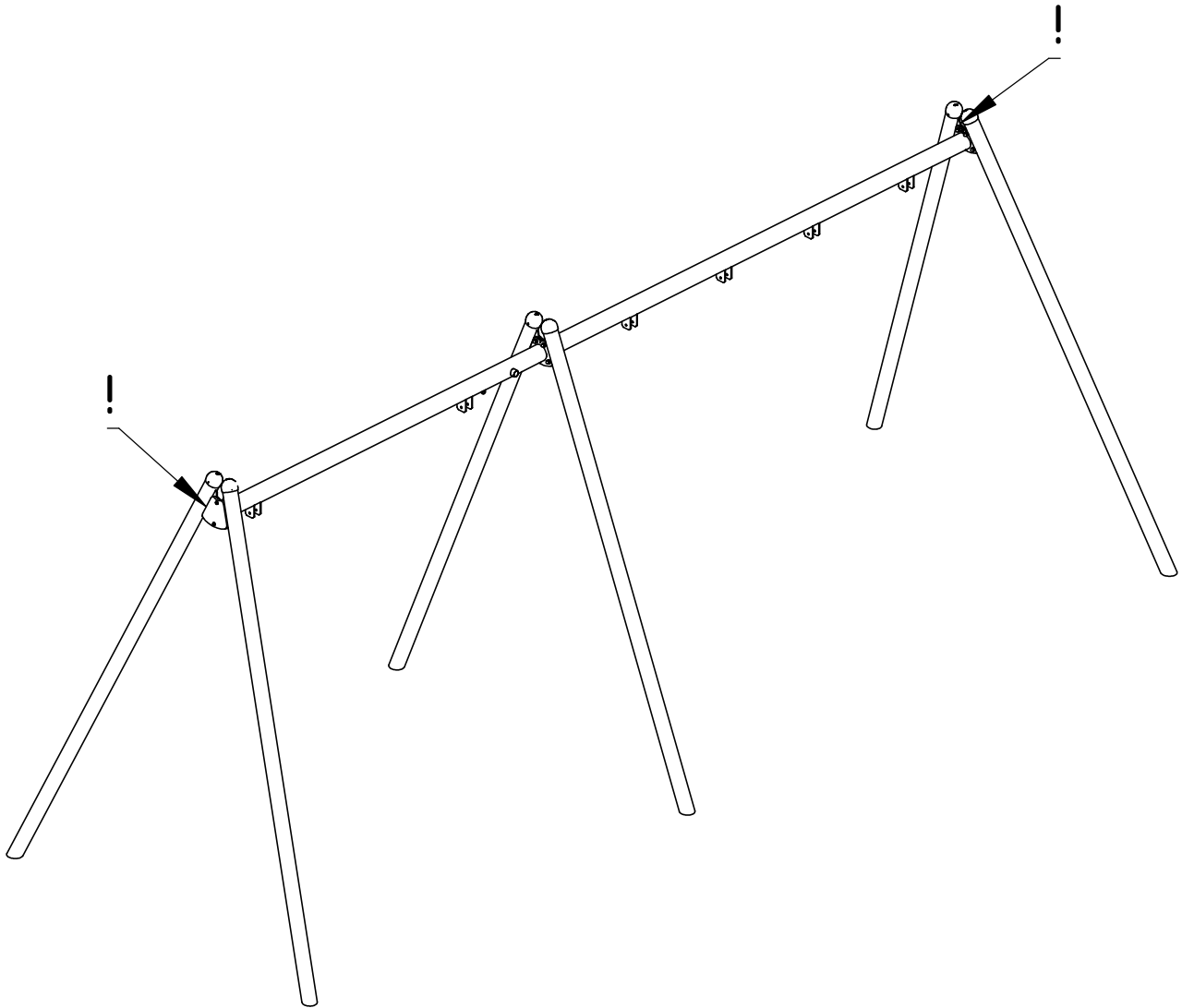

3

3021N

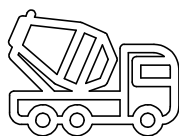
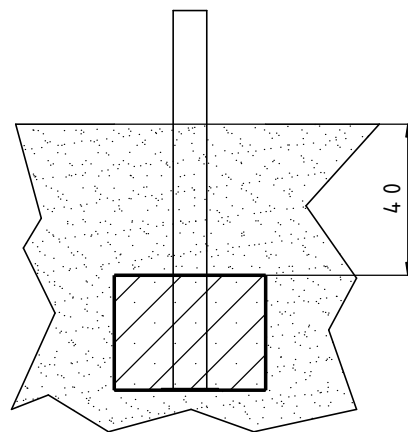
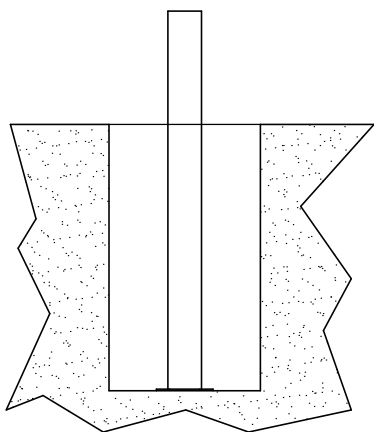
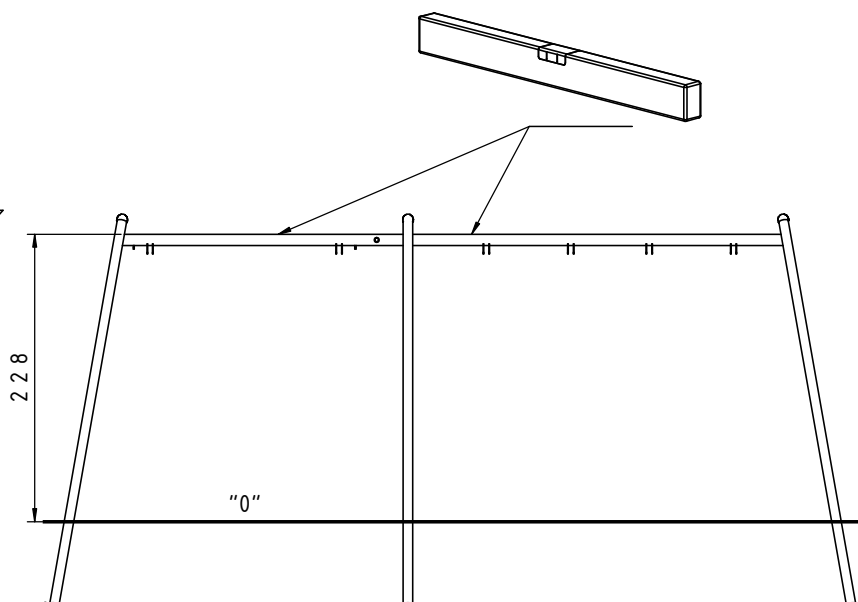
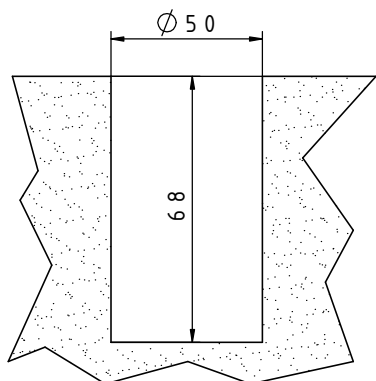
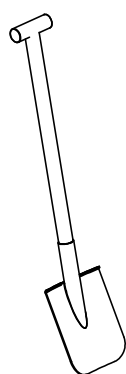
B25 0,4m<sup>3</sup>

min. 48H

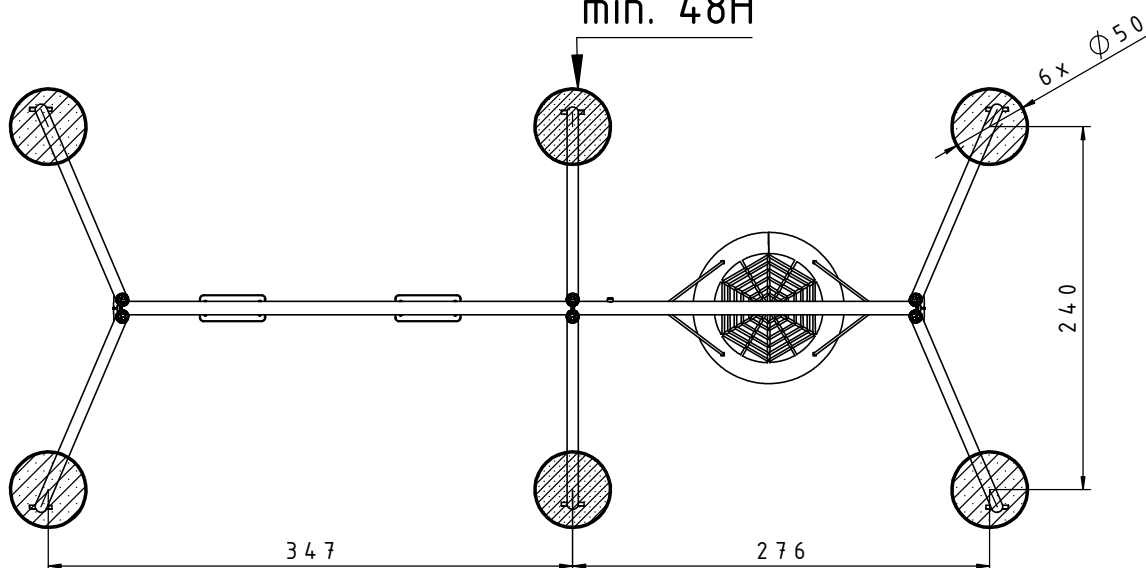

3.1

3021F

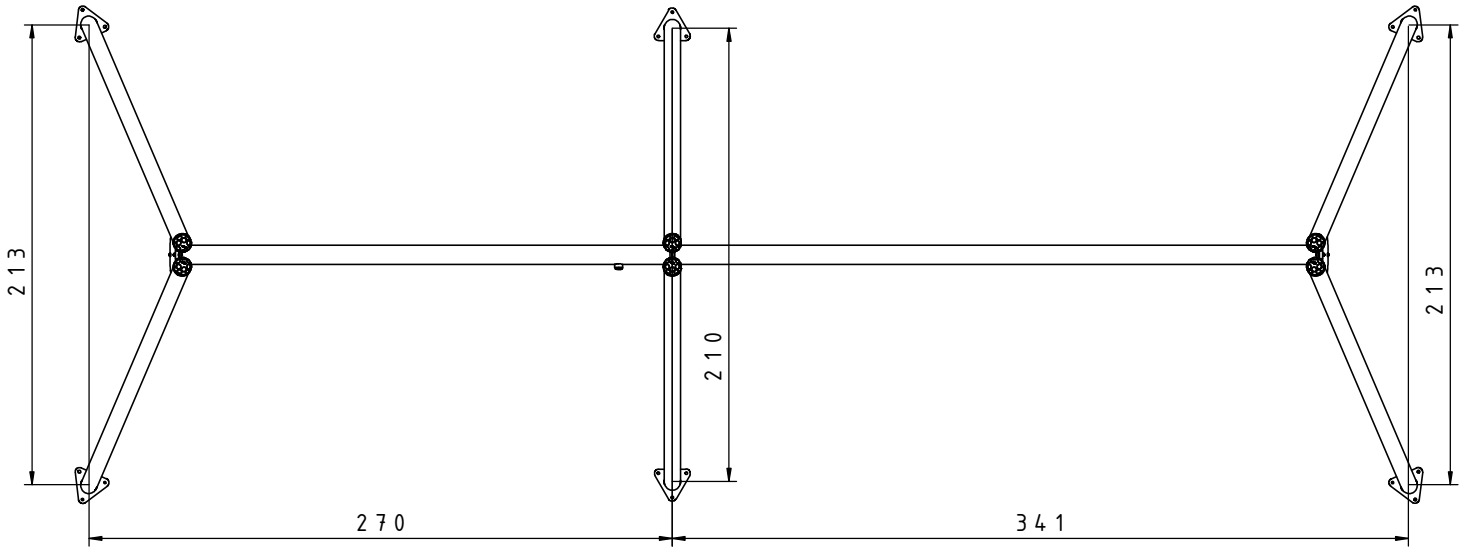
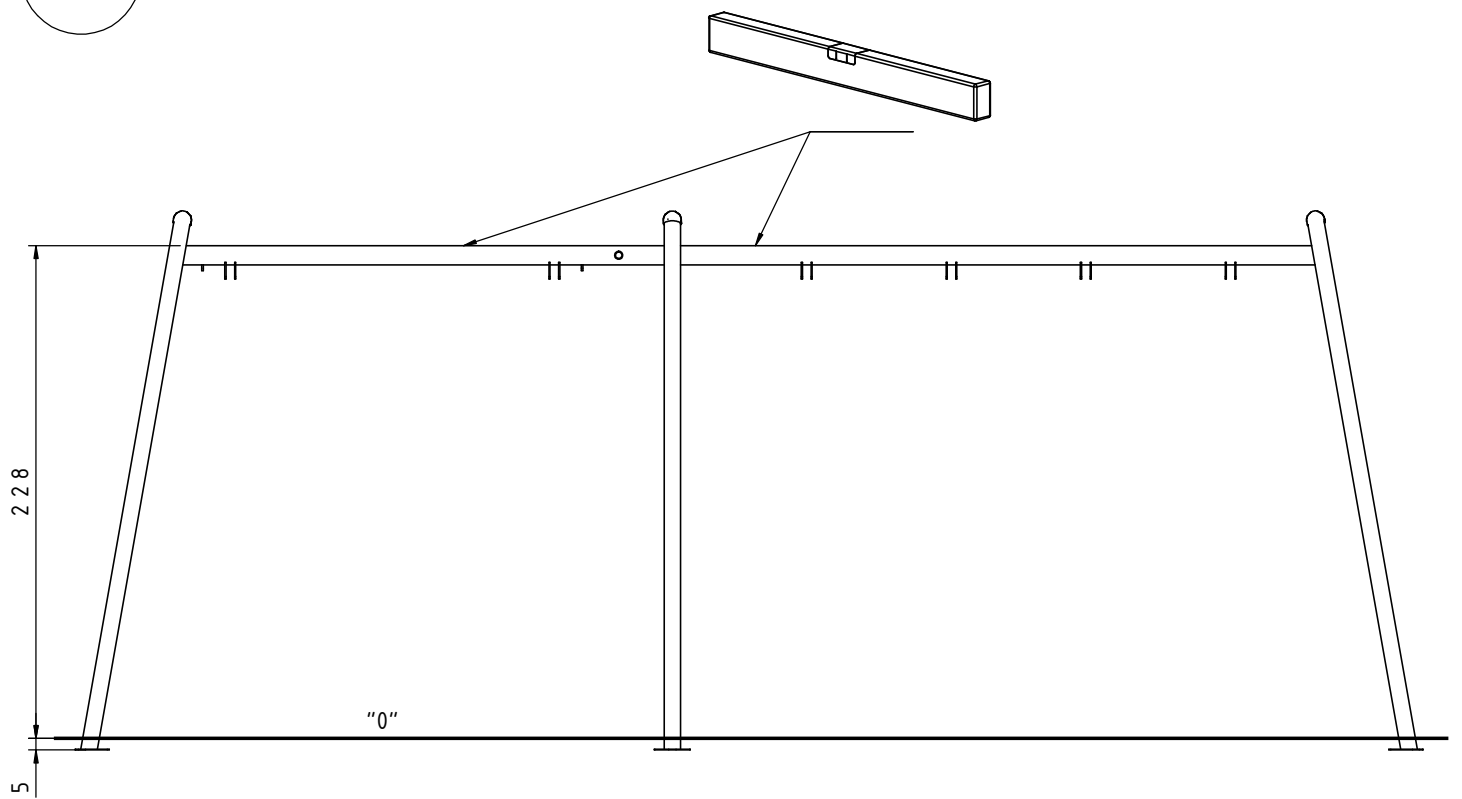

# 3.2 3021F

| Nr | Element   |   |       |
|----|---|---|-------|
| 61 |  | - | KL105 |

I

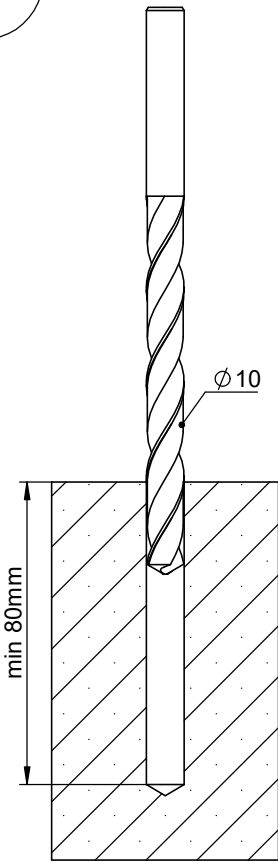

II

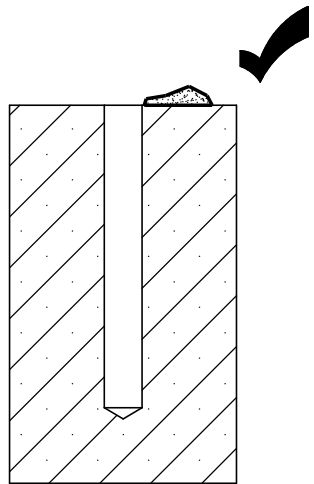
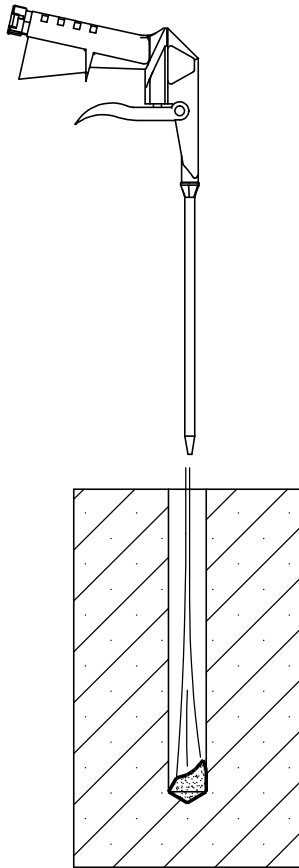

III

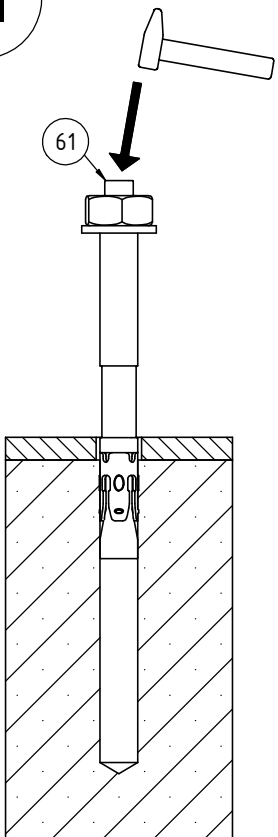

IV

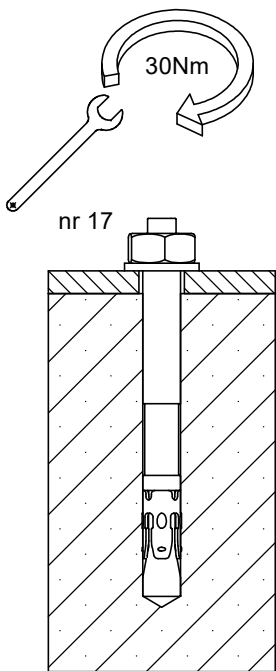

V

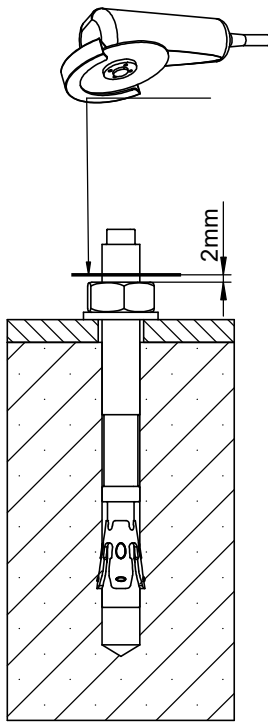

VI

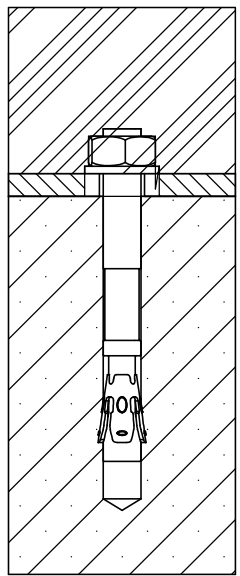



4

3021N  
3021F



INST\_30\_63  
INST\_30\_71  
INST\_Z\_1

